



**CobraTap™**

### Product Description

Thread high and low designed for maximum holding power. Made of temper steel with the special corrosion resistant Cobra coating. Drive and drill bit are included as a bonus in all packs of 25, 75 and 100. Head style: Robertson and Philips combination.



### Features & Benefits

- ▶ HIGH GRADE STEEL to ensure the best torque, pull and shear
- ▶ CORROSION RESISTANT Cobra-Coat to maximize corrosion resistance
- ▶ HIGH & LOW THREAD for an ease of installation and maximum holding power
- ▶ Bonus: Drive & drill bit included in all 25, 75 and 100 piece packs
- ▶ Bonus: Drill bit included in 10 piece packs
- ▶ Combined head (Robertson & Philips)
- ▶ ACQ compatible

### Product sizes & Materials

High Grade Steel with Cobra-Coat  
(Rust resistant coating)

3/16" X 1 1/4"  
3/16" X 1 3/4"  
3/16" X 2 1/4"  
3/16" X 2 3/4"  
3/16" X 3 1/4"  
3/16" X 3 3/4"  
3/16" X 4"  
1/4" X 1 1/4"  
1/4" X 1 3/4"  
1/4" X 2 1/4"  
1/4" X 2 3/4"  
1/4" X 3 1/4"  
1/4" X 3 3/4"  
1/4" X 4"

### Perfect for:



Architectural facades ,Ornamental fixtures ,Signs etc...

### Suitable Base Materials

- ▶ Concrete
- ▶ Brick
- ▶ Hollow Block



## Load Capacities

Material	Diameter Screw Size	Drill Size	Min. Embedment	PULL MAX lbs	PULL SAFE lbs	SHEAR MAX lbs	SHEAR SAFE lbs
Concrete 3000 PSI	3/16 "	5/32"	1-1/4"	650 lbs	162 lbs	800 lbs	200 lbs
	1/4 "	3/16"	1-1/4"	1400 lbs	350 lbs	1700 lbs	425 lbs

*\*\*Always use safe load capacities*

## Tools required



## Installation instructions

1. Drill the appropriate size hole into the base material (click on "Technical Specifications" for applicable drill sizes.)
  - 1.1. Always drill 1/2" deeper than required.
2. Remove dust and debris from the hole.
3. Insert the screw through the object you need to affix and into the drilled hole.
4. Screw clockwise until there is a firm resistance.
5. Recommended embedment between 2" to 2 1/2 " deep.

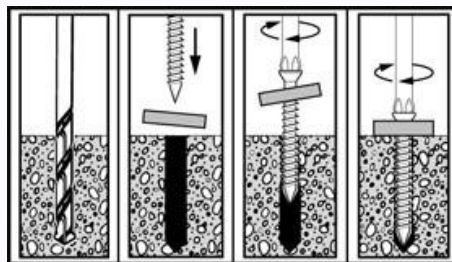

## Packaging:

